

KPA500 KIT ASSEMBLY MANUAL ERRATA

Rev. F6-2, September 24, 2016

E740149E

MAKE THESE CHANGES TO YOUR REV F3 MANUAL OR ANNOTATE THE TEXT TO REFER TO THIS ERRATA AT THE PLACES INDICATED

1. Page 25, replace the last check box step and Figure 34 with the following:

Connect the 270V wire from the power supply module to the PA/LPF module as shown in Figure 34. **Support the pc board so it does not flex while mating the connector.** This is the connector you routed through the hole in the Z-bracket earlier.

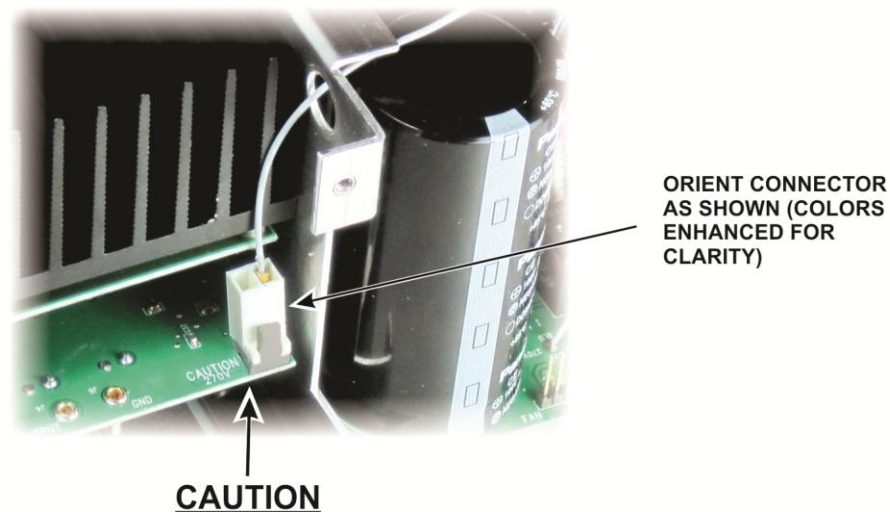

CAUTION
SUPPORT THE BOARD FROM BELOW WITH YOUR FINGERS
WHILE ATTACHING THE CONNECTOR SO THE BOARD CANNOT FLEX.
ALLOWING THE BOARD TO FLEX MAY BREAK COMPONENTS ON THE BOARD.

Figure 34. Connecting the 270V Wire to the PA/LPF Module.

2. Page A-4 (Parts List): Change the serial number label part number from E850187 to E850450.